

X-Refs & Blocks used in this Drawing
 x-osbase
 x-Raster
 x-treatment hatching and key
 x-treatment node points

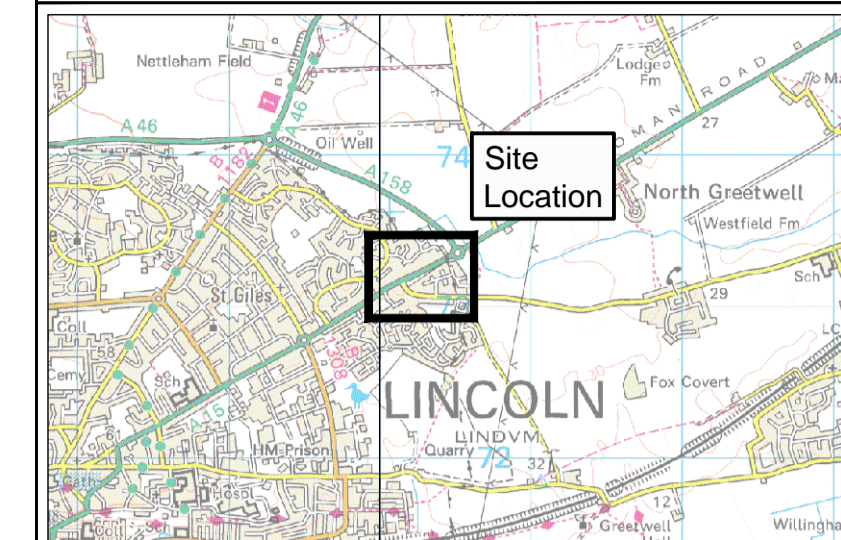

LOCATION PLAN
 Scale 1:50,000

- Key:
- Treatment 1 - Type 'S' 40mm Inlay
 Plane off 40mm from existing levels
 Lay 40mm Surface Course (LCC HRA 30/14F Standard mix)
 - Treatment 2 - Type 'A' 110mm Inlay
 Plane off 110mm from existing levels
 Lay 40mm Surface Course (LCC HRA 30/14F Standard mix)
 Lay 70mm Dense Binder Course
 - Treatment 3 - Type 'B' 150mm Inlay
 Plane off 150mm from existing levels
 Lay 40mm Surface Course (LCC HRA 30/14F Standard mix)
 Lay 110mm Dense Binder Course
 - Treatment 4 - Reconstruction Type 'R'
 Plane off 240mm from existing levels
 Lay 40mm Surface Course (LCC HRA 30/14F Standard mix)
 Lay 60mm Binder, 80mm base + 60mm Base

Reinforcement grid
 Inclusion of reinforcement grid at minimum 110mm below the new surface level. Grid to be to clause 0773AR.

Notes:
 See Appendix 7/1 for full surfacing specification.

Bond coats should be applied on prepared surfaces to ensure adhesion between new layers and substrate.

For areas of reconstruction a minimum 30% CBR foundation is required if this is not achieved additional foundation material will be needed

Core logs (included in Contract documents) indicate that the existing carriageway includes Tar bound material and in places starts as shallow as 38mm below the current surface level. As such all Treatments are likely to include the planing out of contaminated material which will need disposing of in the proper manner. See core log report 71734 for further details.

PRICING

(FOR PRICING PURPOSES ONLY - DO NOT USE FOR CONSTRUCTION)
 FOR THIRD PARTY USE, THIS DRAWING SHALL BE DEEMED CURRENT ONLY AT THE DATE OF APPROVAL. PLEASE CHECK FOR AMENDMENTS BEFORE USE

Rev	Description	Drawn By	CAD By	Approved By	Approval Date

Revision: Description Drawn By CAD By Approved By Approval Date

Amendment Details Drawing 1st Approval

1st Approval by: MCO Date: 22/05/18

Drawn/Designed by: BM CAD Drawing Creation Created By: BM Date: 01/03/18

Scale: 0 10m 20m 30m 40m
 Primary: 1:500 Secondary: (Do not scale from this drawing)

Lincolnshire COUNTY COUNCIL
Highways Alliance
 TECHNICAL SERVICES PARTNERSHIP
 3RD FLOOR MILL HOUSE BRADFORD WHARF NORTH LINCOLN LN1 1YT
 Customer Service Centre: 01522 782070

Drawing Number: HCPEA0047 /01/ 2001
 Scheme Reference: ID Number: Drawing Series No.

Alternative Scheme Code:
 Parish: LINCOLN
 Road No: Structure No:

Description:
BUNKERS HILL

TREATMENT WORKS

LINCOLNSHIRE COUNTY COUNCIL - Reproduced from Ordnance Survey material with the permission of Ordnance Survey on behalf of the Controller of Her Majesty's Stationary Office © Crown copyright. Unauthorised reproduction infringes Crown copyright and may lead to prosecution or civil proceedings. OS Licence 1000025370
 BSI 05/2018 Issue 2013

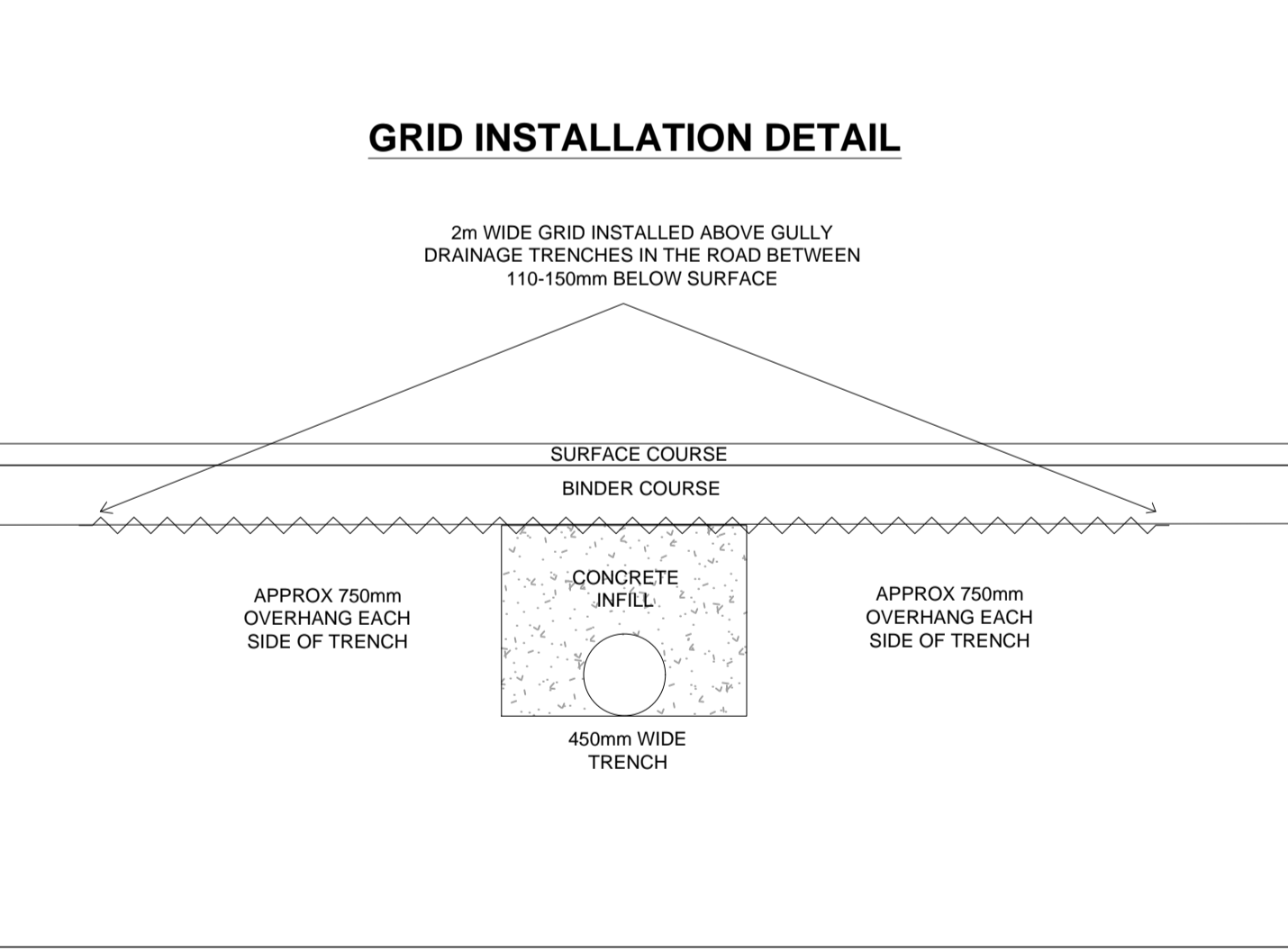
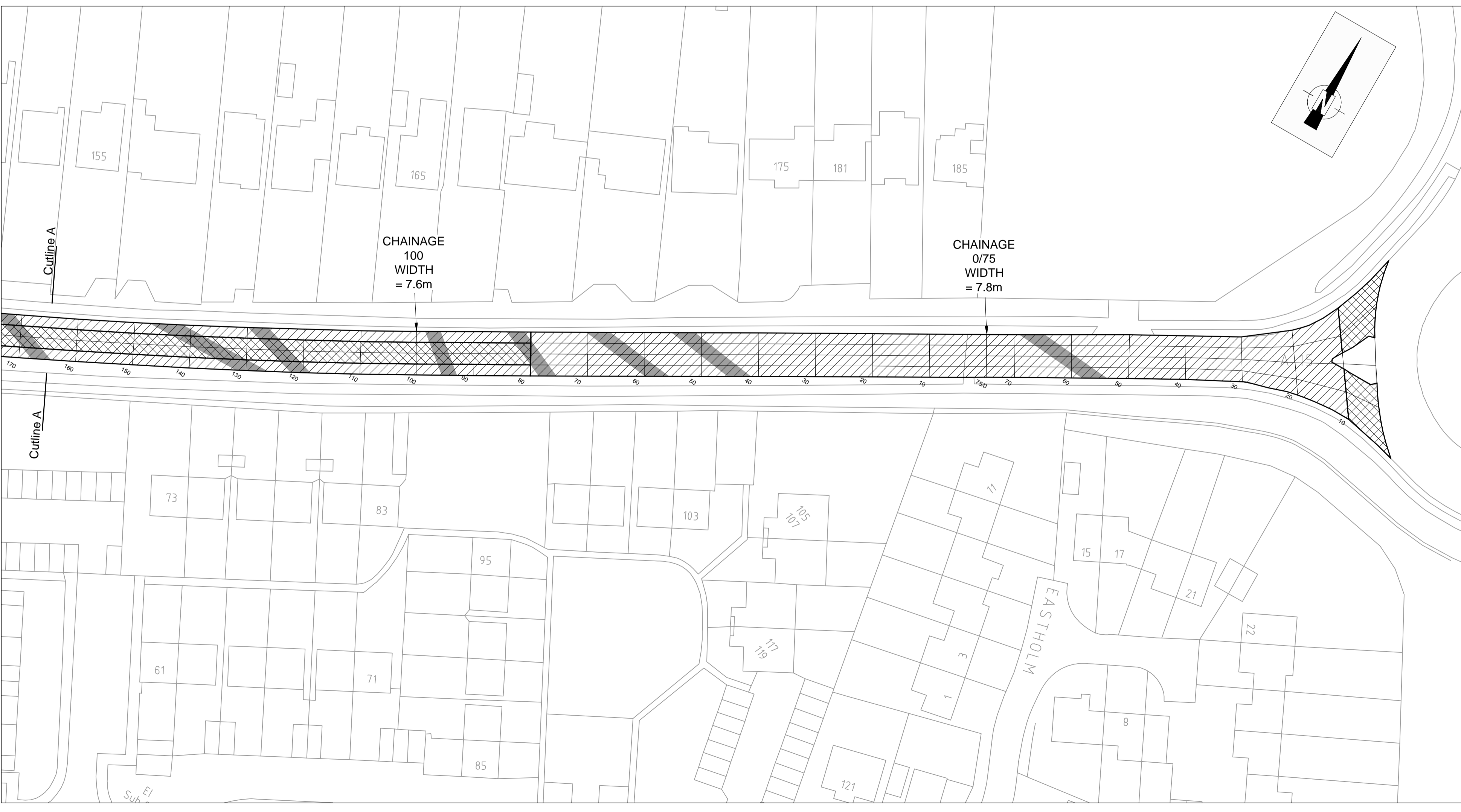
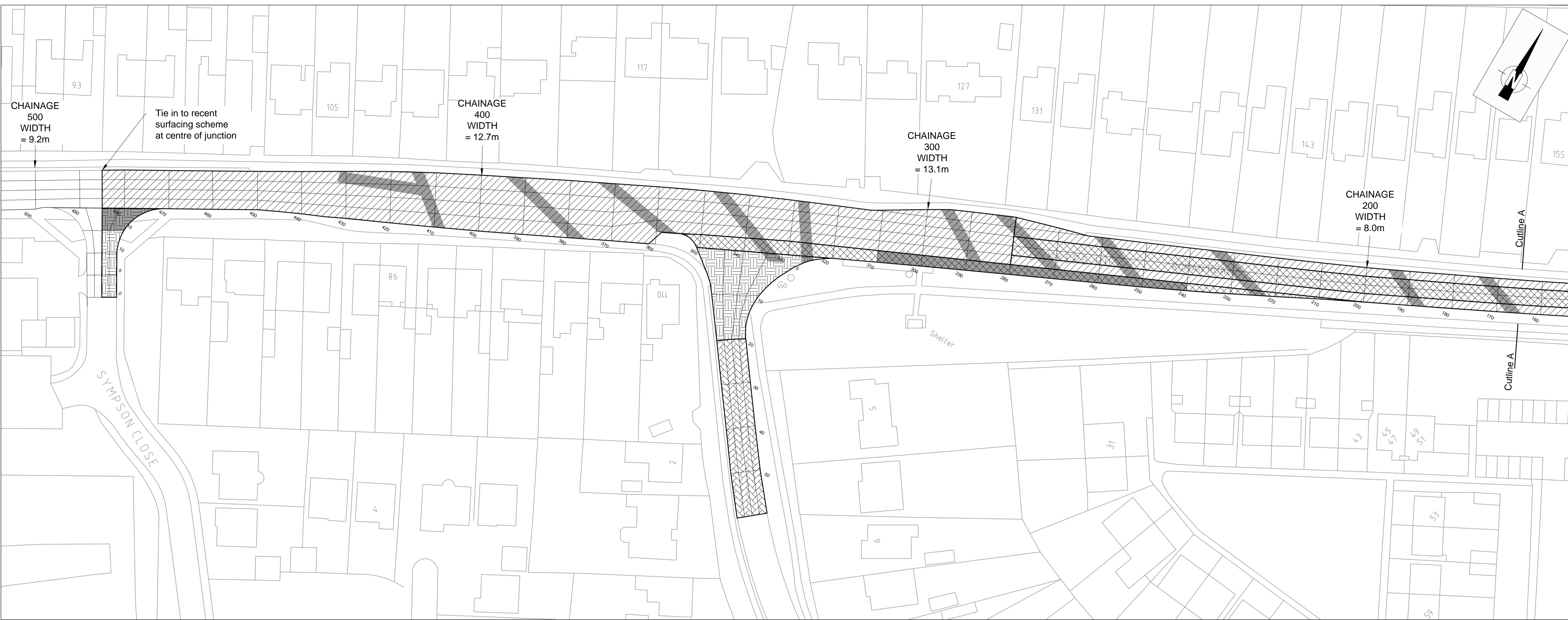

GRID INSTALLATION DETAIL

2m WIDE GRID INSTALLED ABOVE GULLY DRAINAGE TRENCHES IN THE ROAD BETWEEN 110-150mm BELOW SURFACE

SURFACE COURSE
 BINDER COURSE
 CONCRETE INFILL
 450mm WIDE TRENCH
 APPROX 750mm OVERHANG EACH SIDE OF TRENCH